

| Product Code | Description |
|--------------|--------------------------------------|
| JC821PC-W | 1 Gang RJ45 Cat 6 Data Socket Outlet |

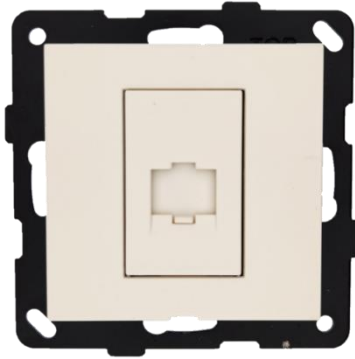

JC821PC-W-LWH

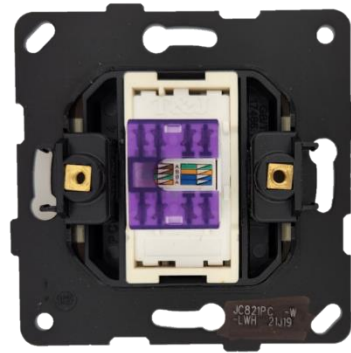

Product back view

Technical Specification

- With shutter dust cover
- Punch down termination
- Compatible CAT6 jack:
RJD-60U8883-05B
(Unshielded, Dual IDC Jack, White)
-support both T568A & T568B wiring
- Fix Centre: 60.3 mm
- Fix Screw: M3.5 x 0.6 x 25mm±

With Lavina '95 Frame: JC1401

- Dimensions: 95x95x10mm (WxHxD)
- Mounting box: >30mm depth
 - J1040, flush mounting, plastic
74.5 x 74.5 x 42mm (W x H x D)
 - M1050, flush mounting, metal
75.5 x 64 x 50mm (W x H x D)

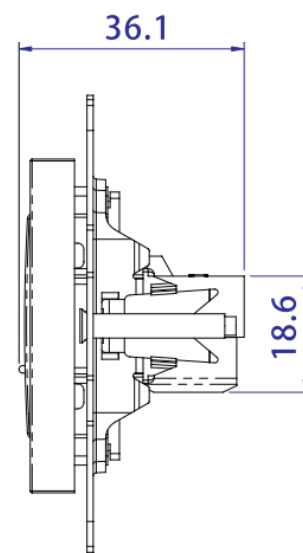
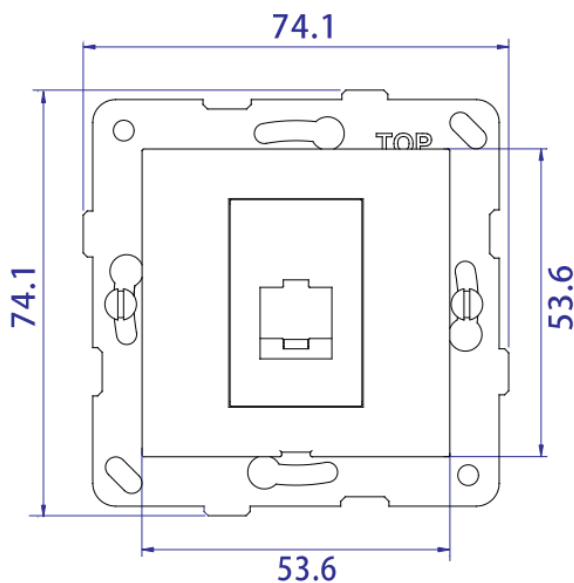

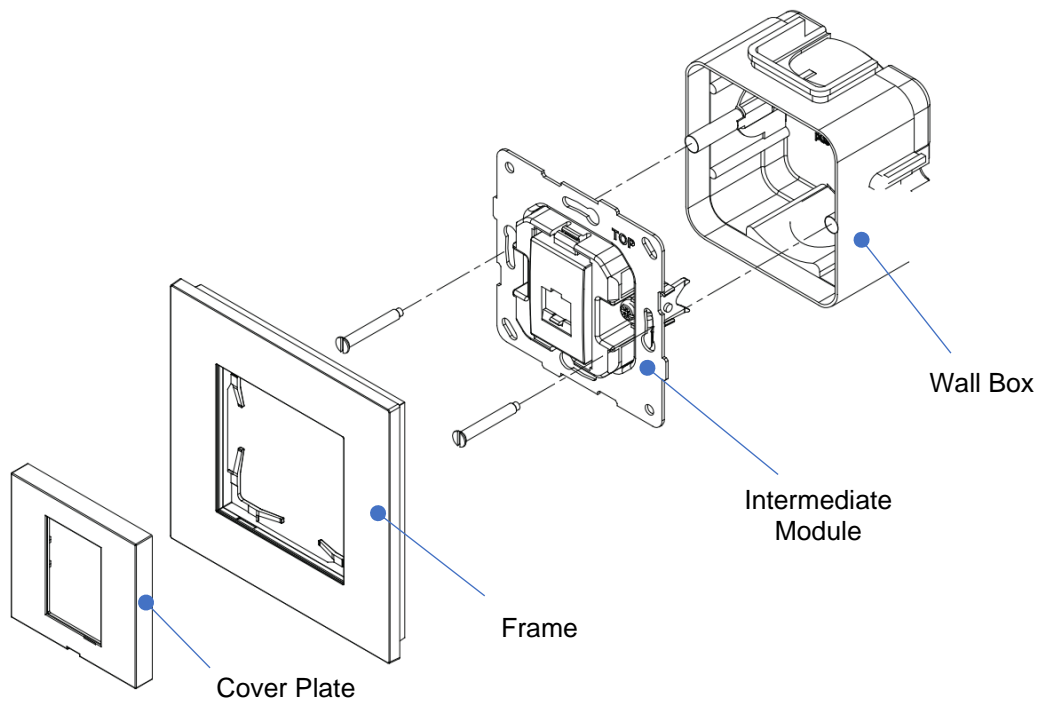

Product dimensions (mm)

Single-gang Assembly

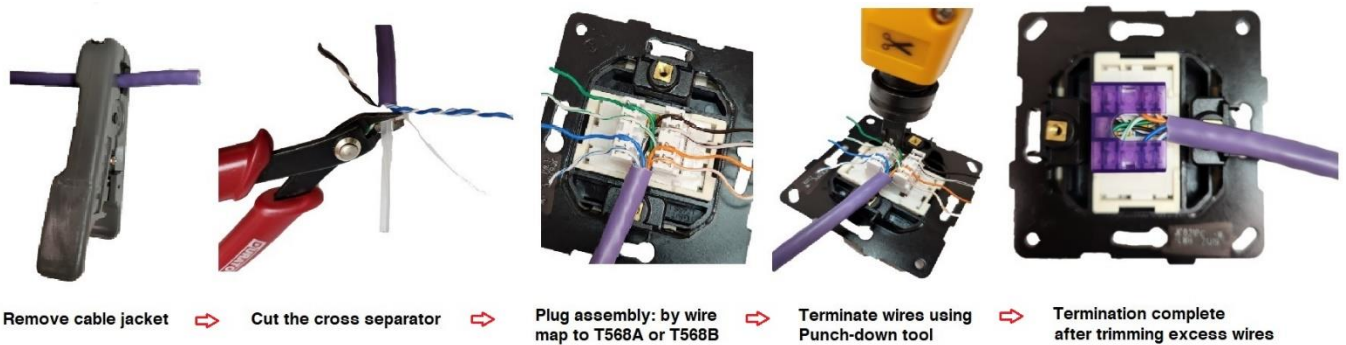

Typical Wiring Guide (for reference)



| Product Code | Colour |
|---|--|
| JC821PC -W-LWH |  Matt White |
| JC821PC-W-LBL |  Matt Black |
| <i>For other colours, please contact T&J Sales representative</i> | |